

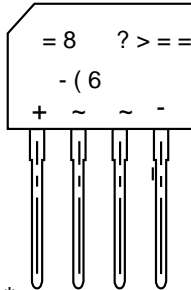

: 5 * % 3

8OWUDVRIW 5HFRYHU\ %ULGJH



3, 11, 1*

3, 1	'(6&5,37,21
	,QSXW 3A Q
	,QSXW 3A Q
	2XWSXW \$ Q RGH
	2XWSXW & A W KRG H

) HDWXUHV
 ‡*OD 3 DVVLY 8DWL 3G FWLRQ
 ‡5HYH 9R 10 WDJH9
 ‡)RUZ D&XG UHQW
 ‡+LJ 6XU &XUU 8HDSW ELOLW\
 ‡'HVLJQR 6XUIDRX \$ 8/SOLF DWLRQ
 %HQHILWV
 ‡&DVH%3
 ‡7HUPL 6ROG H 3B 0H 67'

0D[LPXP 5DWLQ 0G 0HFW 8K 8D 0FWHULVWLFV

5DWLQWV &PEL MGH SHUD 0XUMKHU/SHFLILHG
 6LQJOH SKDVH K 0IHZ 0RULQGX FOR 0H 0HDSDFLWEXHU 0R0HWH

3DUDPHWHU	6\PEROV	:5*%3	8QLWV
0D[LPXP 5HSHWLWLYH 3HDN 5 95 5DU VH 9ROWDJH	9506		9
0D[LPXP 506 YROWDJH	9506		9
0D[LPXP '& %ORFNLQJ 9ROWDJH &			9
\$YHUDJH 5HFWLILHG 2XWSXW & XUUHQW			\$
5HYHUVH 5HFRYHU\ 7LPH ,) \$,5 \$,55 \$	7UU		XV
3HDN)RUZDUG 6XUJH &XUUHQW +DOI 6LQH :DYH 6XSHULPSRV, H 00 RQ 5DWHG /RDG -('(& 0HWKRG		PV 6LQJOH H 00 RQ 5DWHG	\$
, WUDW 8DVLQ 8V W PV	, W		\$ 6
0D[LPXP)RUZDUG WDW H\$	9)		9
0D[LPXP '& 5HYHUVH &XUUHQW #7\$ DW 5DWHG '& %ORFNLQJ 9ROWDJH #7\$		f & f &	\$
7\SLFDO -XQFWLR 0 8RVS 8 FLWD 0 8H			S)
2SHUDWLQJ DQG 6WRUDJH 7H 8H WDWXUH 5DQJH			f &
1RWH 0HDVX 0 0G+] DQG 8SS OLLH 8HYUR 0HVRD 8H&			



: 5 * % 3

5 \$ 7 , 1 * 6 \$ 1 ' & + \$ 5 \$ & 7 (5 , 6 7 , & 6 & 7 5 9 (6 X Q O H V V R W K H U Z L V H Q R W H G

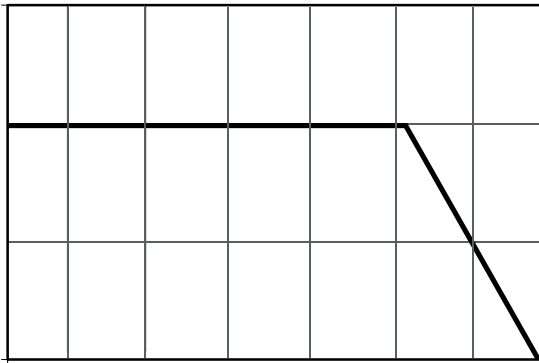

7 F & D V H^R & 7 H P S

Current Derating

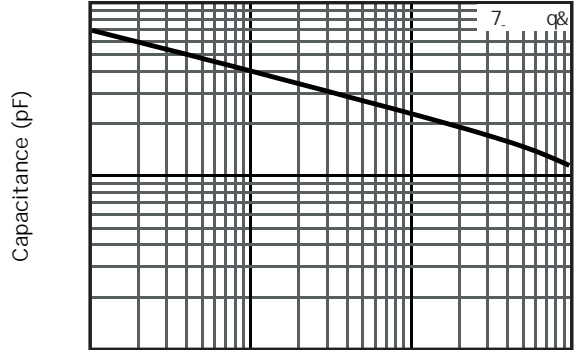

Reverse Voltage(V)

Typical Junction Capacitance

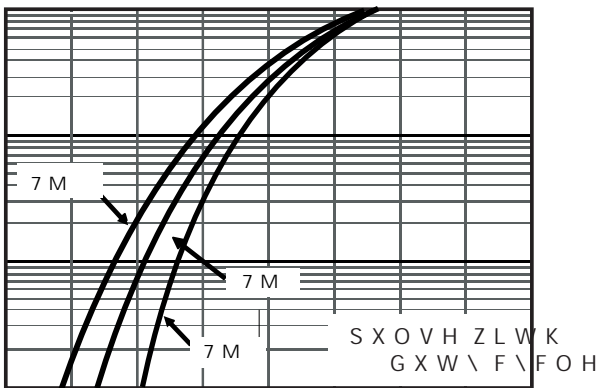

9 I , Q V W D Q W D Q H R R 0 W 0 W 7 D U G

Typical Forward Voltage

5 H Y H U V 1 0 \$ & X U U H O W

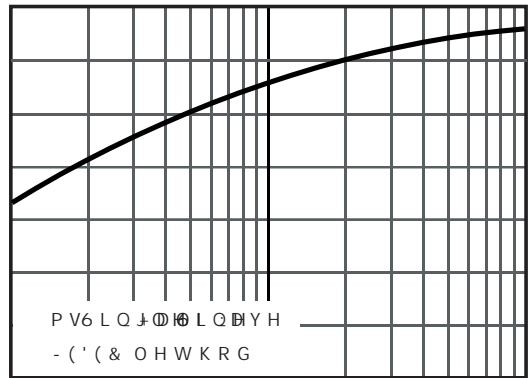

9 5 5 H Y H U V H 9 1 0 0 W D J H

Typical Reverse Current



: 5 * % 3

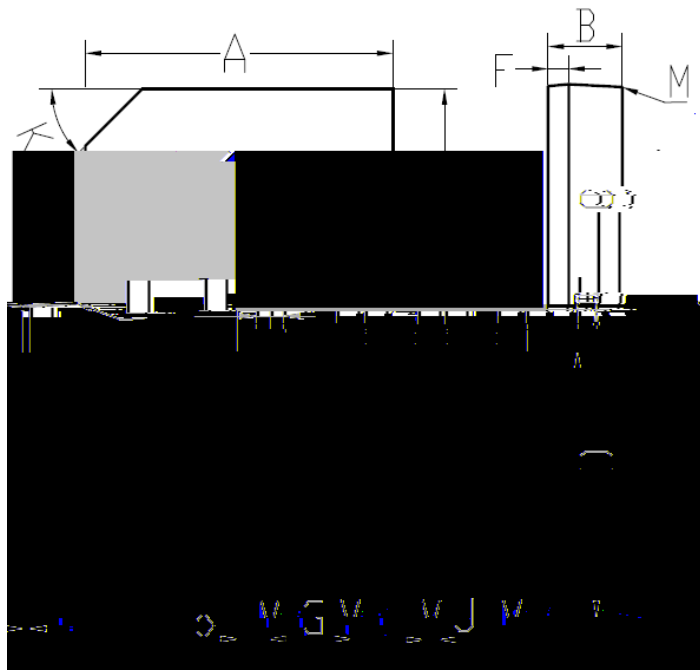

GBP		
DIM.	MIN.	MAX.
A	14.20	14.70
B	3.30	3.60
C	10.20	10.60
D	13.80	14.40
d	1.40	1.70
E	1.80	2.20
F	0.80	1.10
G	3.71	3.91
H	0.30	0.55
I	1.22	1.42
J	0.76	0.86
K	2.7 x 45° (Typ)	
L	#	3°
M	#	2°
All Dimensions in millimeter		